

CAMBRIDGE CITY COUNCIL

Report by: Head of Policy and Projects

To: South Area Committee

Date: 09 September 2010

Wards: Trumpington, Queen Edith's, Cherry Hinton

Environmental Improvements Programme

1 DECISIONS TO BE MADE

- **Wulfstan Way Local Centre**

***Decision:** Whether to implement the scheme subject to positive consultation at an estimated cost of £101,000.*

2 BUDGET (See over)

SOUTH AREA COMMITTEE

Environmental Improvements Programme 2010-2011

Total Budget Available to 31/3/11 **£255,586**

ADOPTED PROJECTS	COMPLETE	Total Spend Previous Years £	Forecast Spend 2010/11 £	TOTAL SCHEME COST £	Approved Budget £
Cherry Hinton High Street hanging baskets (2010)		0	7,850	7,850	7,850
Cherry Hinton High Steet Verges	✓	577	39,423	40,000	40,000
Fisher's Lane Verge Parking		8	24,742	24,750	24,750
total cost to implement adopted projects			72,015		
Uncommitted Budget			183,571		
SCHEMES UNDER DEVELOPMENT*		Total Spend to Date £	Total Estimated Cost £		
Rectory Terrace - Cherry Hinton High St Shop Forecourt [SCHEME ON HOLD]		0	60,000		
Wulfstan Way Local Centre		0	101,000		
total estimated cost of projects in development		0	161,000		
Uncommitted Budget			22,571		

*Projects agreed by Cttee to be investigated, but no budget committed. Costs shown are estimated and will depend on detailed design and site investigation. N.B. The estimated costs shown above are merely given as a rough guide until the projects can be designed and costed.

3 APPROVED SCHEMES – PROGRESS

3.1 Rectory Terrace, Cherry Hinton High Street Forecourts

This scheme is on hold whilst the developer proposals to redevelop the site are determined.

3.2 Cherry Hinton High Street Verges

This scheme has now been completed.

3.3 Clarendon Road/Shaftsbury Road

A scoping consultation is currently being carried out for this area, which was due to complete at the end of August. This has been extended to the end of September at the request of Councillor Stuart. The results will be presented to the next South Area Committee in November.

4.0 SCHEMES REQUIRING DECISIONS

4.2 Wulfstan Way Local Centres Scheme

A workshop with traders, interested local residents and stakeholders took place on Tuesday 22nd June. This identified key design aspects for further development.

The plan in Appendix 1 of this report shows the proposed layout of this scheme, which includes:

- New higher quality paving of forecourt areas and footway links.
- Feature seating area with possible semi-circular bench involving public art.
- Five new parking spaces and improved definition of existing bays.
- New Notice Board.
- New cycle racks.
- Raised carriageway to create flush crossing at existing zebra crossing point.
- Improved highway lighting and lighting of the forecourt.
- Recycling area upgraded.
- Crown lifting of large tree.
- Improvements to planting bed layouts and replanting of one existing tree.

The current estimated cost of this scheme is £173,473. It is proposed that South Area Committee contribute £101,000 from the Environmental Improvement Programme. A further £26,473 is available from S106 public realm funding, £17,000 from public art S106 and £29,000 from the Environmental Safety fund for improvements to lighting.

Subject to the agreement of this Committee, Officers now propose to carry out a local public consultation on the attached proposals. The scheme could then be implemented in the New Year, subject to the results of the consultation.

Recommendation: *That the Committee agree to implement the scheme subject to positive consultation at an estimated cost of £101,000.*

Decision: *Whether to implement the scheme subject to positive consultation at an estimated cost of £101,000.*

7.0 IMPLICATIONS

(A) **Equal Opportunities Implications**

Covered as one of the assessment criteria

(c) **Environmental Implications**

The whole purpose of this programme is to bring about improvements in the environment

(d) **Community Safety Implications**

Covered as one of the assessment criteria

8.0 INSPECTION OF PAPERS

To inspect or query the background paperwork or report, please contact,

Andrew Preston

Environmental Projects Manager

Telephone: 01223 - 457172

Email: andrew.preston@cambridge.gov.uk

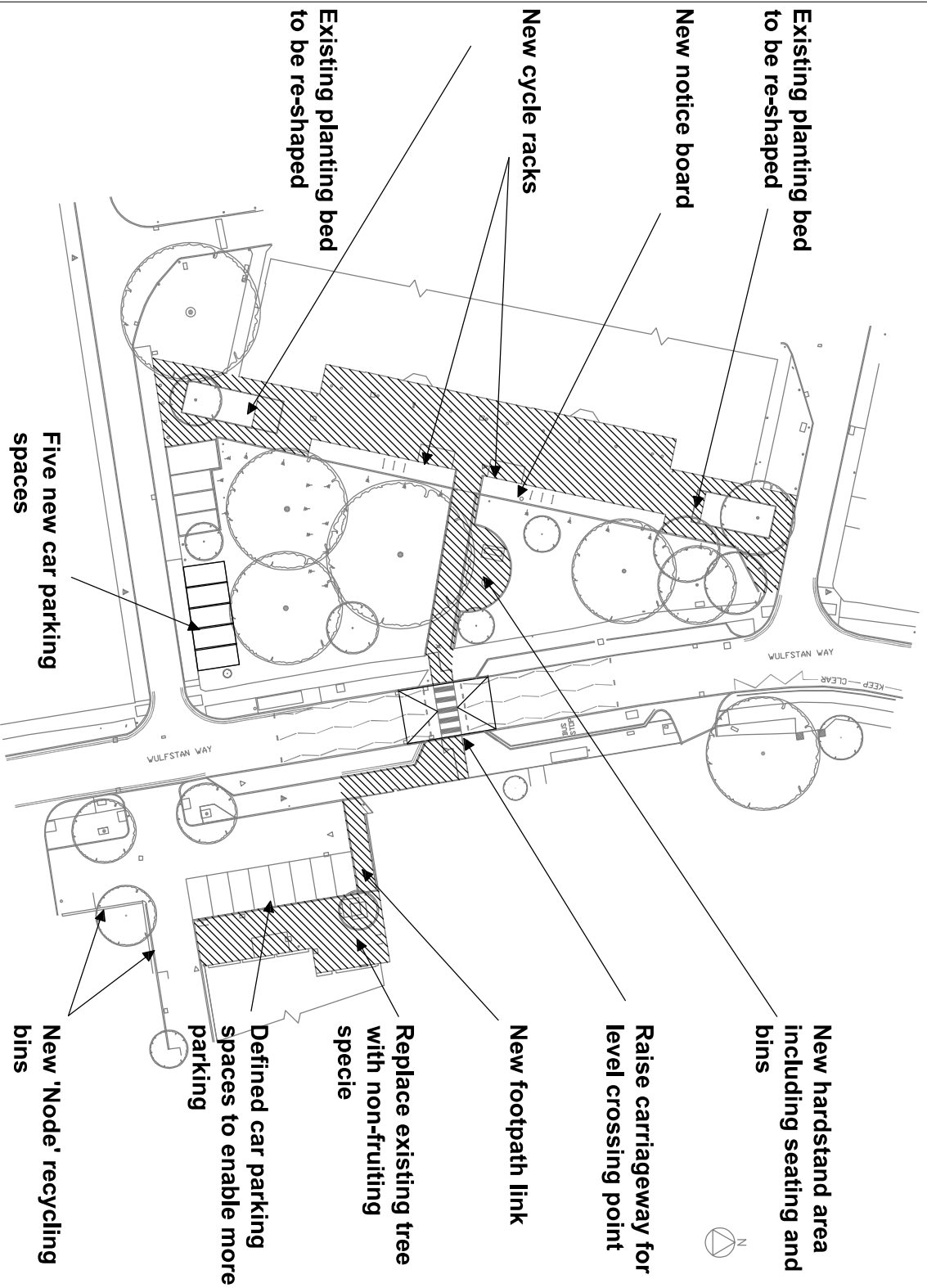

Area Wide Improvements

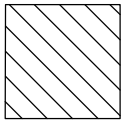
 Improved Paving
New high quality concrete paving in a buff colour to enhance the link between the two areas

 Improved Street Lighting
New high quality street lighting



ENVIRONMENT AND PLANNING DEPARTMENT
URBAN DESIGN TEAM
 Simon Payne, Director of Environment and Planning
 CAMBRIDGE CITY COUNCIL
 The Guildhall, Cambridge CB2 3QU
 Tel: 01223 - 457200 or 457201

Revision	Date	By	Details

Scale 1: 500 @A3	Drawn: AH	Checked: AP	Date AUG 2010
<small>"The map is reproduced from Ordnance Survey material with the permission of Her Majesty's Stationery Office © Crown copyright. Unauthorised reproduction of this map is prohibited. All rights reserved. Ordnance Survey Licence No: 100019750/2010." DO NOT SCALE Contractors must take the dimensions in preference to scaled dimensions. Contractors, sub-contractors and suppliers must verify all dimensions on site before commencing any work or making any shop drawings. Discrepancies to be brought to the contract administrator's / landscape architect's attention."</small>			

Project:	Wulfstan Way - Local Improvement scheme
Drawing:	Layout Plan
Job Ref / DWG.No	EIP 020_158_002
Revision	

APPENDIX TWO

ELIGIBILITY CRITERIA - as agreed by Executive Councillor (Environment) on 18 March 2003 with amendments agreed 22 March 2005

The essential criteria for consideration of funding of Environmental Improvement works are:

- Schemes should have a direct, lasting and noticeable improvement to the appearance of a street or area.
- Schemes should be publicly visible and accessible.
- Schemes must have the owners consent if on private land – unless there are exceptional circumstances by which Area Committee may wish to act unilaterally and with full knowledge and responsibility for the implication of such action.
- Schemes must account for future maintenance costs.

Desirable criteria – potential schemes should be able to demonstrate some level of:

- Active involvement of local people.
- Benefit for a large number of people.
- 'Partnership' funding.
- Potential for inclusion of employment training opportunities.
- Ease and simplicity of implementation.
- Potential for meeting key policy objectives (e.g. improving community safety or contributing to equal opportunities).

Categories of scheme ineligible for funding:

- Where a readily available alternative source of funding is available.
- Revenue projects.
- Schemes that have already received Council funding (unless it can be clearly demonstrated that this would not be 'top up' funding).
- Works that the City or County Council are under an immediate obligation to carry out (e.g. repair of dangerous footways)
- Play areas (as there are other more appropriate sources of funding including S106 monies)

The following categories of work were agreed as being eligible for funding by the Area Committees:

- Works in areas of predominately council owned housing
- Works to construct lay-bys where a comprehensive scheme can be carried out which not only relieves parking problems but achieves environmental improvements.